

- Wall proposed
- 2008 phase fabric
- Historic fabric
- GIS wall construction

Overview of proposed work

1. First floor of cottage converted back to living accommodation, with all external walls internally insulated
2. New bathroom fitted
3. Stair closed off at first floor level, with a timber stud wall in a reversible manner
4. New kitchen fitted, retaining original leach tiles
5. Office refurbished for use as studio for resident potter
6. External stair to be used as main access, balustrading to be replaced and treads repaired
7. New entrance building
8. PV added to existing production building

For details of the repair items highlighted in blue (and additional repair items highlighted in green), refer to the repair schedule

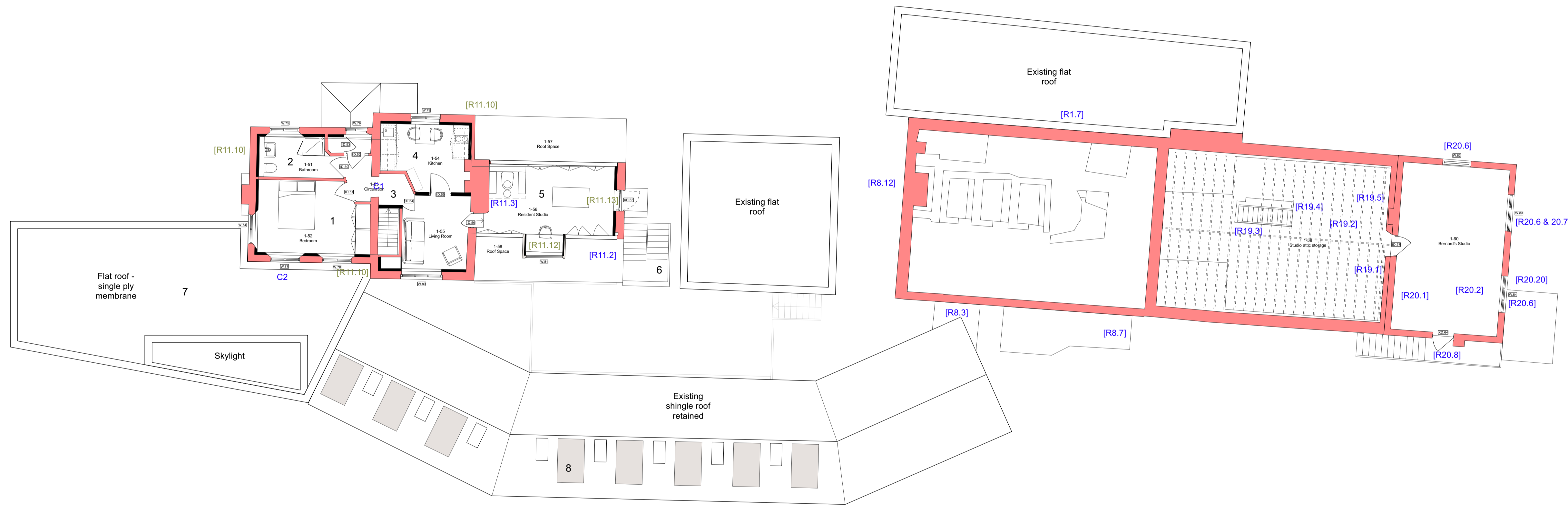

- E 01/09/23 Additional annotation
- D 27/07/23 Updated GA's + annotation
- C 10/07/23 VE incorporated + additional annotation
- B 23/09/22 Additional annotation
- A 04/07/22 Updated GA's

DOW JONES ARCHITECTS

Units 1-5, 11 Sancroft Street, London SE11 5UG
 T 020 7587 1555
 mail@dowjonesarchitects.com
 www.dowjonesarchitects.com

Leach Pottery

First Floor Plan - Proposed
 1:100 @ A1
 01.06.2022
 STATUS: PLANNING

488-00-115 E

1 First Floor Plan - Proposed
 Scale: 1:100

